

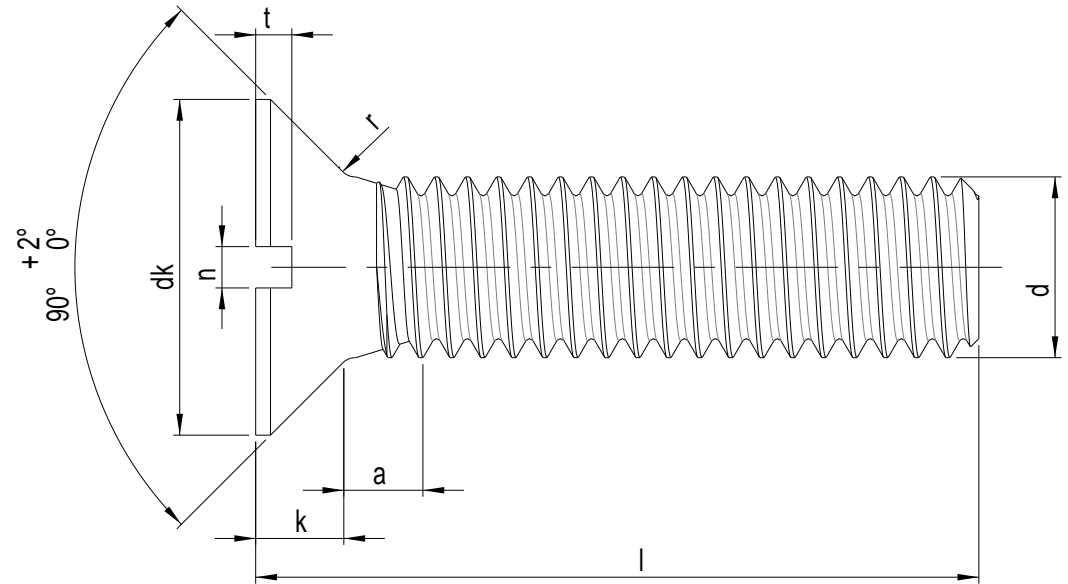

## Further Information

Diameter (d)	Pitch	dk	k (max)	n (nom)	t (min)
M1.0	0.25	1.90-1.76	0.60	0.25	0.20
M1.2	0.25	2.30-2.06	0.72	0.30	0.25
M1.4	0.30	2.60-2.46	0.84	0.30	0.28
M1.6	0.35	3.00-2.70	1.00	0.40	0.32
M2	0.40	3.80-3.50	1.20	0.50	0.40
M2.5	0.45	4.70-4.40	1.50	0.60	0.50
M3	0.50	5.60-5.20	1.65	0.80	0.60
M3.5	0.60	7.30-6.14	2.35	0.80	0.70
M4	0.70	8.40-7.14	2.70	1.20	0.80
M5	0.80	9.30-8.84	2.70	1.20	1.00
M6	1.00	11.30-10.57	3.30	1.60	1.20
M8	1.25	15.80-14.07	4.60	2.00	1.60
M10	1.50	18.30-17.57	5.00	2.50	2.00
M12	1.75	22.00-21.48	6.00	3.00	2.40



	<b>Part No. A9630440A4</b>
<p>www.pts-uk.com +44 (0)1342 410758</p>	<p>M4 X 40 SLOT COUNTERSUNK MACHINE SCREW DIN 963 A4 STAINLESS STEEL</p>
<p>Information in this drawing is provided for reference only</p>	